

# NEEDLE ROLLERS

Rollers are needle roller bearings with a reinforced outer ring. They are made with a convex outer surface, R500, to eliminate edging caused by inaccurate roll alignment. Rollers have a gap seal (labyrinth seal), without flexible seals. The working temperature of the rollers is from -20°C to +140°C. Recommended tolerance of shaft manufacturing for mounting of rolling rollers -g6. These bearings are machine parts ready for assembly and can be used in all types of cam mechanisms, transport systems, etc.



### Characteristics:

Rollers are needle roller bearings with a reinforced outer ring.

### Application:

These bearings are machine parts ready for assembly and can be used in all types of cam mechanisms, transport systems, etc.

### Delivery status:

Ready to install filled with operating grease, do not wash. Protected by maintenance oil, packed in corrosion inhibited anti-corrosion paper.

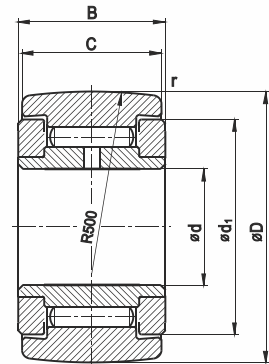

Dimensions						Load capacity		Limit speed	Bearing designation
d	D	B	C	r	d <sub>1</sub>	C Movement	C <sub>0</sub> Resting		
mm	mm	mm	mm	mm	mm	N	N	min.-1	
6	19	12	11	0,3	15	5500	7900	7000	RT 6
8	24	15	14	0,5	19	7800	11400	5500	RT 8
10	30	15	14	1	23	9500	14600	4500	RT 10
12	32	15	14	1	25	9700	15400	3900	RT 12
15	35	19	18	1	27	12800	23000	3400	RT 15
17	40	21	20	1,5	32	14800	26500	2900	RT 17
20	47	25	24	1,5	37	20600	42000	2600	RT 20
25	52	25	24	1,5	42	20500	44000	2100	RT 25
30	62	29	28	1,5	51	30500	63000	1700	RT 30
35	72	29	28	2	58	33000	73000	1400	RT 35
40	80	32	30	2	66	41000	90000	1300	RT 40
50	90	32	30	2	76	40500	93000	1000	RT 50